

## TECHNICAL HIGHLIGHTS

### STRUCTURE

- RCC framed structure with earthquake resistance design.
- 9" & 4 1/2" thick plastered Brick masonry.
- UPVC with glazed shutters.
- Commercial flush doors for other doors.

### JOINERY

- UPVC windows with glazed sliding shutters.
- Flush door for toilets.
- SS Hand rails.
- M.S.Grill in windows and ventilators.

### FLOORING

- Polished Marble / Garnite flooring for common areas.
- Pavars blocks flooring for ground, pavements & drive way.
- Grano flooring for parking areas.
- Vitrified joint-free ceramic tiles for office areas.

### FINISHING

- Smooth Wall plastering with plastic Emulsion paint for interiors.
- Cement paint and emulsion on exterior walls.
- Structural Glazing work for exterior.
- Premiered interior walls for all rooms.
- Exterior to be finished with emulsion on all sides and elevation as per details.
- All stairways to have painted MS-handrails.

### TOILETS

- All floor to have toilet provisions.
- Matt Ceramic Tiles Designer Tiles 7'0" DADO.
- Chrome finished pipe fittings and pastel color sanitary-wares for all toilets.

### ELECTRICAL & SANITARY FITTINGS

- Fire resistant electrical wiring.
- Provision for Telephone cables.
- 3-Phase Electrical connection with all necessary drop points and modular switches.
- 8 Person Capacity auto-lift.
- Generator backup for common areas.

### OTHERS

- Ample Car parks.
- Adequate product display & signage space.
- Abundant light evenly distributed.
- CCTV surveillance system.

**Radiant Real Properties** has to its fame some of coimbatore foremost residential and commercial architecture.

Every product of Radiant stable effort is exclusive and places the legatee a class apart. Radiant Real Properties, A perfect blend of imperishable layouts and green engineering.



## LOCATION MAP

For Booking : 96594 99999



Promoted by  
**RADIANT REAL PROPERTIES INDIA PVT. LTD.**  
JS Empire, Tirchy Road, Opp.Stanes,  
Coimbatore - 641018.

Mobile: +91 96594 99999  
info@radiantassets.com  
www.radiantassets.com

RADIANT  
**JS EMPIRE**

THE FUTURISTIC  
OFFICE SPACE

RADIANT  
**JS EMPIRE**

**JS EMPIRE** - Radiant in vogue - Coimbatore's finest commercial destination. Trichy Road today boasts of its latest landmark at Ramanathapuram.

Your office represents the fundamental forefront of what you stand for. It is the very pride of what you do. The very contentment of downtown life. The very comfort of work space and the very success of your effort.

This is the very platform on which JS EMPIRE is built. Truly aristocratic. So talk to us to get your office space tailored exclusively to fit your specification.



**Typical Floor plan**

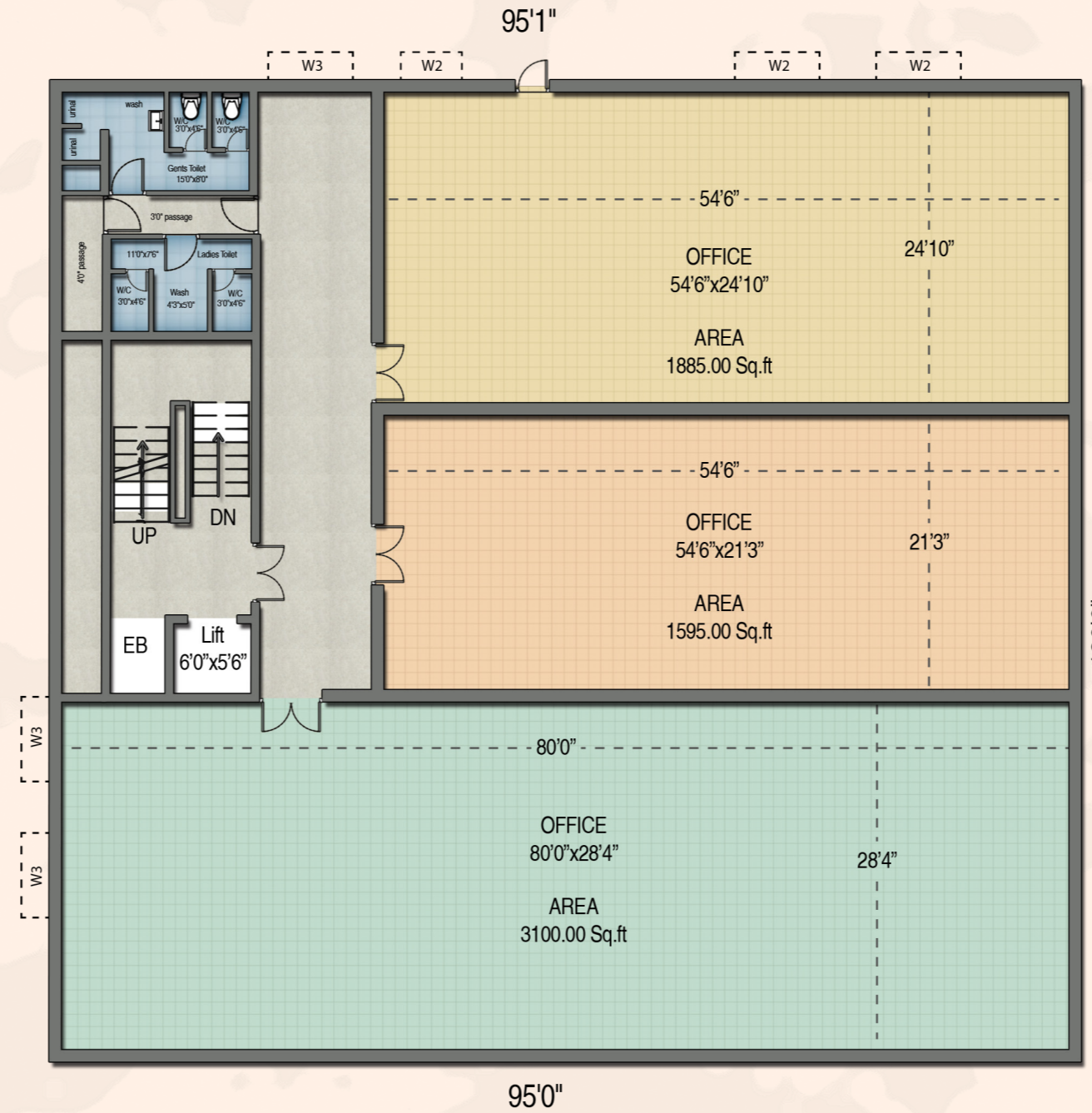

I Floor - 6315 sq.ft

II Floor - 6315 sq.ft

III Floor - 6315 sq.ft

**Car Parking**

